

Reference Aerial Image
9843 SE 42nd Pl, Mercer Island

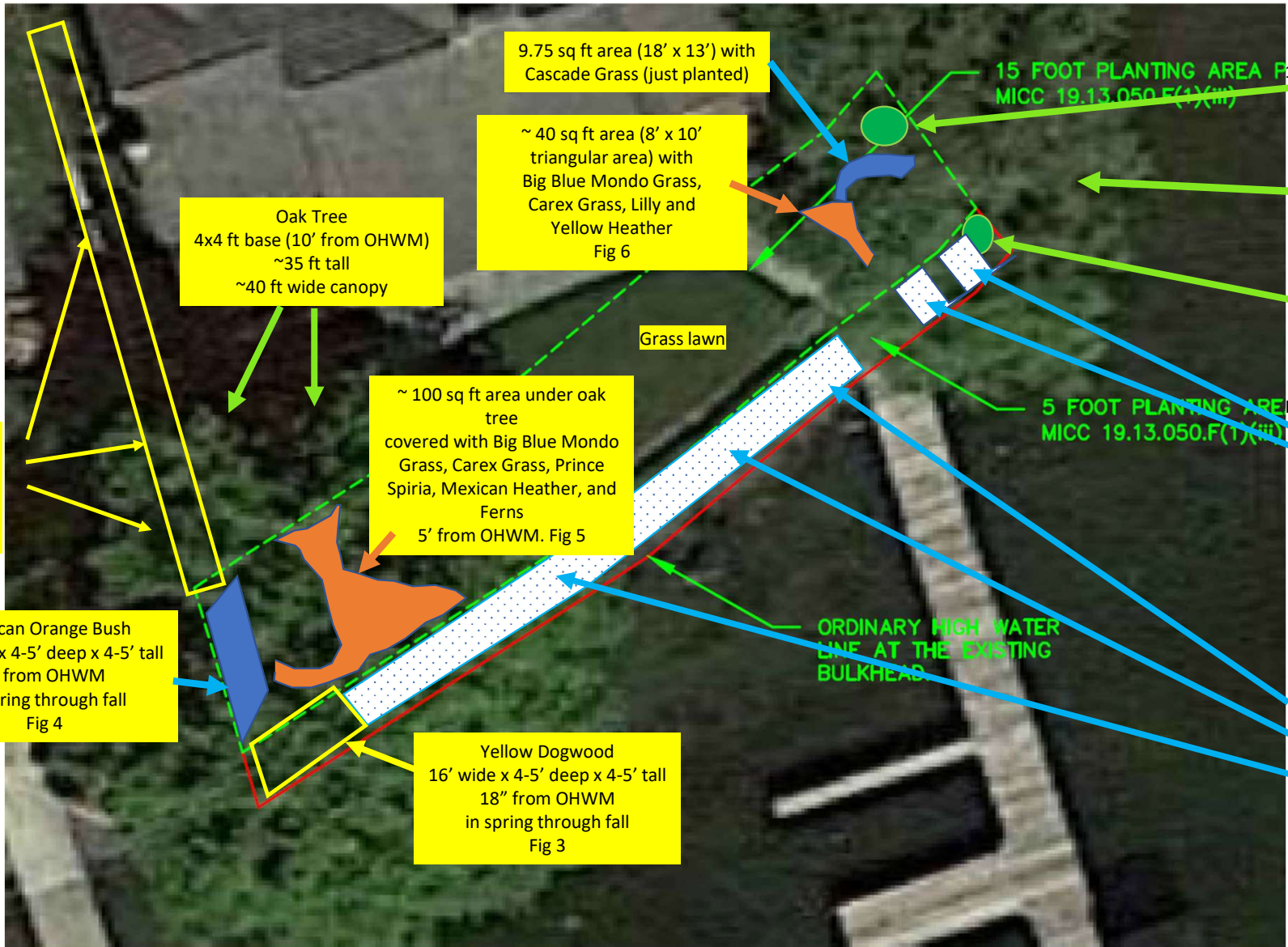

Boxwood Hedge
2' deep x 4' tall
~18' from OHWM
and extends along
east side of house

Oak Tree
4x4 ft base (10' from OHWM)
~35 ft tall
~40 ft wide canopy

9.75 sq ft area (18' x 13') with
Cascade Grass (just planted)

~ 40 sq ft area (8' x 10'
triangular area) with
Big Blue Mondo Grass,
Carex Grass, Lilly and
Yellow Heather
Fig 6

~ 100 sq ft area under oak
tree
covered with Big Blue Mondo
Grass, Carex Grass, Prince
Spiria, Mexican Heather, and
Ferns
5' from OHWM. Fig 5

Mexican Orange Bush
13' wide x 4-5' deep x 4-5' tall
5' from OHWM
in spring through fall
Fig 4

Yellow Dogwood
16' wide x 4-5' deep x 4-5' tall
18" from OHWM
in spring through fall
Fig 3

Grass lawn

ORDINARY HIGH WATER
LINE AT THE EXISTING
BULKHEAD

15 FOOT PLANTING AREA
11'x1' at base, flares to 6'x6'
MICC 19.13.050.F(1)(iii)

5 FOOT PLANTING AREA
MICC 19.13.050.F(1)(iii)

Bay Leaf Tree
11'x1' at base, flares to 6'x6'
15 ft tall
Fig 1

Cottonwood Tree
(base on adjacent
property)

Mexican Orange Bush
4 ft wide x 4 ft deep
3 ft tall, 18" from OHWM

Red Twig Dogwood Shrubs
X 2
4 ft wide
4-5 ft deep, 4 ft tall
in spring thru fall
18 inches from OHWM

Red Twig Dogwood Shrubs
50 ft wide
4-5 ft deep, 4-5 ft tall
in spring thru fall
18 inches from OHWM
Fig 2



Figure 1: Bay Leaf Tree



Figure 2: Red Twig Dogwood Shrubs
Along Bulkhead



Figure 3: Yellow Dogwood and Ferns
on Southwest corner by bulkhead
(picture taken during winter)



Figure 4: Mexican Orange Bush
at base of oak tree

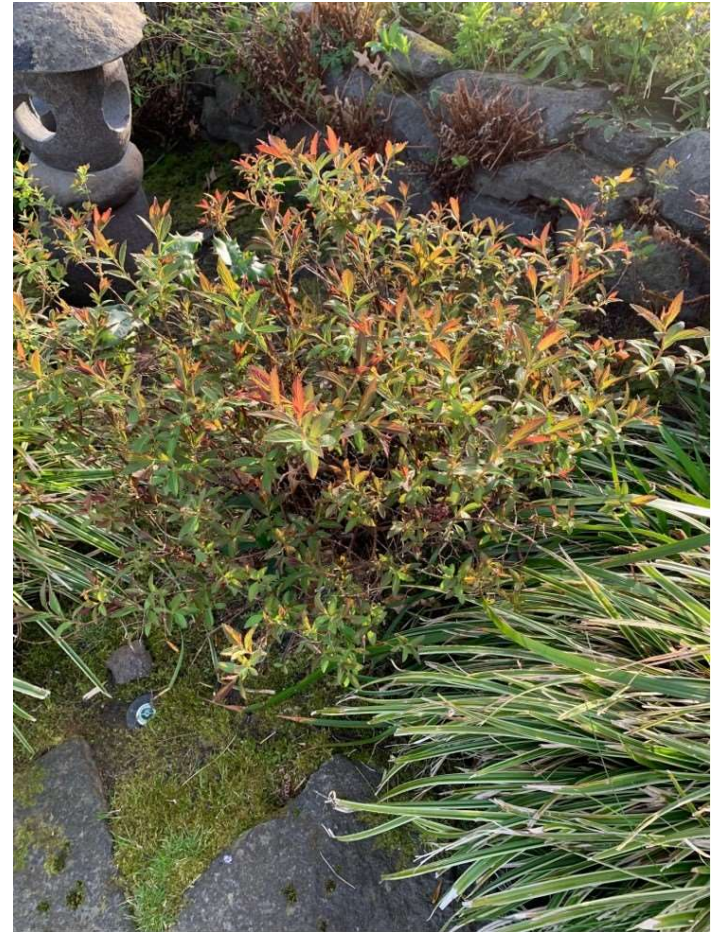

Figure 5: Sword Ferns, Dwarf Spiria, Purple Heliores, Mexican Heather, Prince Spiria, Big Blue Mondo Grass, Carex Grass in Area Under Oak Tree



Figure 6: Big Blue Mondo Grass, Carex Grass, Yellow Heather and Lily